

# Instructions for use

**KitchenAid**



<b>Important safety instructions</b>	<b>4</b>
<b>Safeguarding the environment</b>	<b>6</b>
<b>Before using the appliance</b>	<b>6</b>
<b>Precautions and general recommendations</b>	<b>7</b>
<b>Energy-saving tips</b>	<b>7</b>
<b>Electrical connection for Great Britain and Ireland only</b>	<b>8</b>
<b>Using for the first time</b>	<b>8</b>
<b>Installation</b>	<b>9</b>
<b>Led light system</b>	<b>9</b>
<b>In the event of non-use of the appliance</b>	<b>9</b>
<b>In the event of an interruption to the power supply</b>	<b>9</b>
<b>Functions</b>	<b>10</b>
<b>Use</b>	<b>11</b>
<b>“Fresh 0°” compartment</b>	<b>12</b>
<b>Use of wooden accessories (if present)</b>	<b>14</b>
<b>Food-storage tips</b>	<b>15</b>
<b>Where to store fresh food and beverage</b>	<b>15</b>
<b>Example of food arrangement</b>	<b>15</b>
<b>Functional sounds</b>	<b>16</b>
<b>Recommendation in case of no use of the appliance</b>	<b>17</b>
<b>Maintenance and cleaning</b>	<b>17</b>
<b>Troubleshooting guide</b>	<b>18</b>
<b>After-sales service</b>	<b>19</b>

## Important safety instructions

- **WARNING:** to avoid a hazard due to instability, positioning or fixing of the appliance must be done in accordance with the manufacturer instructions.
  - **WARNING:** keep the appliance ventilation openings clear of obstruction.
  - **WARNING:** do not damage the appliance refrigerant circuit pipes.
  - **WARNING:** Do not use mechanical, electric or chemical means other than those recommended by the Manufacturer to speed up the defrost process.
  - **WARNING:** Do not use or place electrical devices inside the appliance compartments if they are not of the type expressly authorised by the Manufacturer.
  - **WARNING:** (if present) ice-makers and/or water dispensers not directly connected to the water supply must be filled with potable water only.
  - **WARNING:** (if present) automatic ice-makers and/or water dispensers must be connected to a water supply that delivers potable water only, with main water pressure between 0,17 and 0,81 MPa (1,7 and 8,1 bar).
- Information:** This appliance does not contain CFCs. The refrigerant circuit contains R600a (HC).
- Appliances with Isobutane (R600a): isobutane is a natural gas without environmental impact, but is flammable. Therefore, make sure the refrigerant circuit pipes are not damaged. Keep special attention in case of damaged pipes emptying the refrigerant circuit.
  - C-Pentane is used as blowing agent in the insulation foam and it is a flammable gas. Pay special attention during disposal operations.
  - This appliance is intended to be used in household and similar applications such as
    - staff kitchen areas in shops, offices and other working environments;
    - farm houses and by clients in hotels, motels and other residential type environments;
    - bed and breakfast type environments;
    - catering and similar non-retail applications
  - Do not store explosive substances such as aerosol cans with a flammable propellant in this appliance.
  - This appliance can be used by children aged from 8 years and above and persons with reduced physical, sensory or mental capabilities or lack of experience and knowledge if they have been given supervision or instruction

concerning use of the appliance in a safe way and understand the hazards involved.

- Cleaning and user maintenance shall not be made by children without supervision.
- To avoid the risk of children becoming trapped and suffocating, do not allow them to play or hide inside the appliance.
- It must be possible to disconnect the appliance from the power supply by unplugging it if plug is accessible, or by means of an accessible multi-pole switch installed upstream of the socket in conformity with national safety standards.
- Plug the appliance into a grounding socket: the appliance must be correctly connected to an approved earthing system.
- Do not use single/multi adapters or extension cords.
- During installation, make sure the appliance does not damage the power cable.
- Do not pull the appliance power cable
- The appliance must be handled and installed by two or more persons.
- Installation and maintenance including replacement of the supply cord must be carried out by the manufacturer or a qualified technician, in compliance with the manufacturer's instructions and the local safety regulations in force. In order to avoid a hazard do not repair or replace any part of the appliance including the supply cord, unless specifically stated in the user manual.

## Safeguarding the environment

### 1. Packing

The packing material is 100% recyclable and bears the recycling symbol ♻️. For disposal, comply with the local regulations. Keep the packing materials (plastic bags, polystyrene parts, etc.) out of the reach of children, as they are a potential source of danger.

### 2. Scrapping/Disposal

The appliance is manufactured using recyclable material.

This appliance is marked in compliance with European Directive 2002/96/EC on Waste Electrical and Electronic Equipment (WEEE). By ensuring the correct disposal of this appliance, you can help prevent potentially negative consequences for the environment and the health of persons.

The symbol  on the appliance, or on the accompanying documents, indicates that this appliance should not be treated as domestic waste but must be taken to a special collection centre for the recycling of electrical and electronic equipment. When scrapping the appliance, make it unusable by cutting off the power cable and removing the doors and shelves so that children cannot easily climb inside and become trapped.

## Before using the appliance

**To ensure best use of your appliance, carefully read the operating instructions which contain a description of the product and useful advice. Keep these instructions for future reference.**

**1.** After unpacking the appliance, make sure it is not damaged and that the door closes properly. Any damage must be reported to the dealer within 24 hours of delivery of the appliance.

Scrap the appliance in compliance with local regulations on waste disposal, taking it to a special collection centre; do not leave the appliance unattended even for a few days, since it is a potential source of danger for children. For further information on the treatment, recovery and recycling of this product, contact your competent local office, the household waste collection service or the shop where you purchased the appliance.

### Declaration of conformity

- This appliance has been designed for preserving food and is manufactured in compliance with Regulation (CE) No. 1935/2004.
- This appliance has been designed, manufactured and marketed in compliance with:
  - safety objectives of the "Low Voltage" Directive 2006/95/CE (which replaces 73/23/CEE and subsequent amendments);
  - the protection requirements of Directive "EMC" 2004/108/EC.

- 2.** Wait at least two hours before switching the appliance on, to ensure that the refrigerant circuit is fully efficient.
- 3.** Clean the inside of the appliance before using it.

## Precautions and general recommendations

### INSTALLATION

- Be careful not to damage the floors (e.g. parquet) when moving the appliance.
- Make sure the appliance is not near a heat source.
- Install and level the appliance on a floor strong enough to take its weight and in a place suitable for its size and use.
- The appliance is arranged for operation in places where the temperature comes within the following ranges, according to the climatic class given on the rating plate. The appliance may not work properly if it is left for a long time at a temperature outside the specified range.

Climatic Class	Amb. T. (°C)
SN	From 10 to 32
N	From 16 to 32
ST	From 16 to 38
T	From 16 to 43

- Make sure the voltage specified on the rating plate corresponds to that of your home.

### SAFE USE

- Do not store or use petrol, flammable liquids or gas in the vicinity of this or other electrical appliances. The fumes can cause fires or explosions.

## Energy-saving tips

- Install the appliance in a dry, well ventilated room far away from any heat source (e.g. radiator, cooker, etc.) and in a place not exposed directly to the sun. If required, use an insulating plate.
- To guarantee adequate ventilation follow installation instructions.
- Insufficient ventilation on back of the product increases energy consumption and decreases cooling efficiency.
- The internal temperatures of the appliance may be affected by the ambient temperature, frequency of door opening, as well as location of the appliance. Temperature setting should take into consideration these factors.
- Allow warm food and drinks to cool down before placing in the appliance.
- Do not obstruct the fan (if available) with food items.
- After placing the food check if the door of compartments closes properly, especially the freezer door.
- Reduce to a minimum door opening.
- When thawing frozen food, place them in the

- Do not swallow the contents (non-toxic) of the ice packs (in some models).
- Do not eat ice cubes or ice lollies immediately after taking them out of the freezer since they may cause cold burns.
- For products designed to use an air filter inside an accessible fan cover, the filter shall be always in position when the refrigerator is in function.
- Before carrying out any maintenance or cleaning operation, unplug the appliance or disconnect it from the power supply.
- Use the refrigerator compartment only for storing fresh food and the freezer compartment only for storing frozen food, freezing fresh food and making ice cubes.
- Do not store glass containers with liquids in the freezer compartment since they may break.
- Avoid storing unwrapped food in direct contact with internal surfaces of the refrigerator or freezer compartments.
- "The bulb used inside the appliance is specifically designed for domestic appliances and is not suitable for general room lighting within the home (EC Regulation 244/2009)".

**The Manufacturer declines any liability for injury to persons or animals or damage to property if the above advice and precautions are not respected.**

- refrigerator. The low temperature of the frozen products cools the food in the refrigerator.
- Appliances could have special compartments (Fresh Food Compartment, Zero Degree Box,...). In case not differently specified in the specific booklet of product, they can be removed, maintaining equivalent performances.
- Positioning of the shelves in the refrigerator has no impact on the efficient usage of energy. Food should be placed on the shelves in such way to ensure proper air circulation (food should not touch each other and distance between food and rear wall should be kept).
- You can increase storage capacity of frozen food by removing baskets and, if present, Stop Frost shelves, maintaining an equivalent energy consumption.
- Damaged gasket must be replaced as soon as possible.
- High energy class products are fitted with high efficiency motors that remain operational for longer, but have a low power consumption. Do not worry if the engine continues to run for longer periods.

## Electrical connection for Great Britain and Ireland only

### Warning - this appliance must be earthed

#### Fuse replacement

If the mains lead of this appliance is fitted with a BS 1363A 13amp fused plug, to change a fuse in this type of plug use an A.S.T.A. approved fuse to BS 1362 type and proceed as follows:

1. Remove the fuse cover (A) and fuse (B).
2. Fit replacement 13A fuse into fuse cover.
3. Refit both into plug.

#### Important:

The fuse cover must be refitted when changing a fuse and if the fuse cover is lost the plug must not be used until a correct replacement is fitted.

Correct replacement are identified by the colour insert or the colour embossed in words on the base of the plug.

Replacement fuse covers are available from your local electrical store.

#### For the Republic of Ireland only

The information given in respect of Great Britain will frequently apply, but a third type of plug and socket is also used, the 2-pin, side earth type.

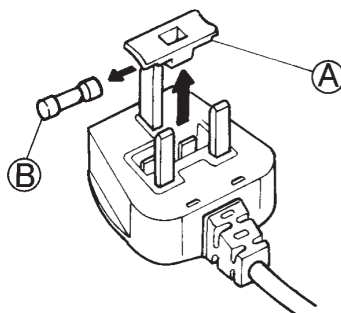

#### Socket outlet / plug (valid for both countries)

If the fitted plug is not suitable for your socket outlet, please contact After-sales Service for further instruction. Please do not attempt to change plug yourself. This procedure needs to be carried out by a qualified technician in compliance with the manufactures instructions and current standard safety regulations.

## Using for the first time

Connect the appliance to the power supply.

In models with electronics, a sound signal may be emitted, which means that the temperature alarm has been activated: press the sound alarm off button. Where provided, position the antibacterial anti-odour filter in the fan as demonstrated in the filter packaging.

**Note:** After turning the appliance on, you must wait for 6 hours for the correct storage temperature to be reached for a normally filled appliance.



## Installation

To guarantee adequate ventilation, leave a space on both sides and above the appliance.

The distance between the rear of the appliance and the wall behind the appliance should be at least 50mm.

A reduction of this space will increase the Energy consumption of product.

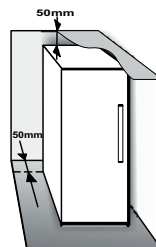

### INSTALLING TWO APPLIANCES

During installing the freezer 1 and the fridge 2 together ensure that the freezer is located on the left and the fridge on the right (as shown on the drawing).

Left side of refrigerator is equipped with special device in order to avoid condensation problems between appliances.

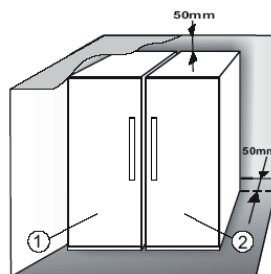

We recommended installing two appliances together using the linking-kit 3 (as shown on the drawing).



## Led light system

The light system inside the fridge compartment uses LEDs light, allowing a better lightning as well as very low energy consumption.

If the LED light system does not work, please contact the Service to replace it.

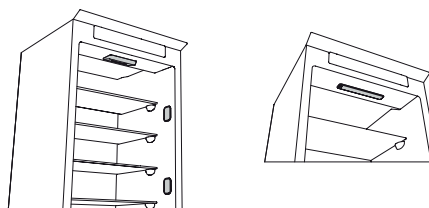

## In the event of non-use of the appliance



Disconnect the appliance from the power supply, empty it, defrost it (if necessary) and clean it. Keep the doors slightly ajar to let air circulate inside the compartments. By doing this, you avoid the development of mould and bad odours.

## In the event of an interruption to the power supply



Keep the doors closed so the food stays cold for as long as possible. Do not re-freeze food that has partially defrosted. If there is a prolonged power cut, the black out alarm may also activate (in products with electronics).

## Functions



### ON/STAND BY

This function turns On/Stand-by the refrigerator. To put the product in Stand-by, press & hold the On/Stand-by button  for 3 seconds. When the appliance is in Stand-by, the light inside the refrigerator compartment does not work. Remember that this operation does not disconnect the appliance from the power supply. To switch the appliance On again, simply press the On/ Stand-By button .

### SMART DISPLAY

This optional function can be used to save energy. To activate/deactivate the Smart Display, press and hold Vacation  and Fast Cool  buttons at the same time for 3 seconds until an audible signal sounds. After activation of the Smart Display, the display goes off. Smart Display is active - to adjust the temperature or use other functions, it is necessary to activate the display by pressing any button. After about 15 seconds without performing any action, the display goes off again. When function is deactivated the normal display is restored. The Smart Display is automatically disabled after a power failure. Remember that this function does not disconnect the appliance from the power supply, but only reduces the power consumed by external display.  
**Note:** The declared appliance energy consumption refers to operation with the Smart Display function activated.

### DOOR OPEN ALARM

The Alarm icon  lights up blinking and the acoustic alarm sounds. The alarm is activated when the door is left open for more than 2 minutes. To disengage the door alarm close the door, or press once Stop Alarm button  to mute the acoustic alarm.

### VACATION

This function can be activated to reduce the energy consumption of the appliance during a period of absence. Before activating the feature, all perishable food should be removed from the refrigeration compartment and make sure that the door is closed properly, since the refrigerator will maintain a suitable temperature to prevent the formation of unpleasant odors (+12°C).

To activate/ deactivate press the Vacation mode button for 3 seconds. When the function is enabled, the related symbol will light up and the temperature of the refrigerator compartment will be set to a higher setpoint (the temperature display will show the new temperature setpoint of +12°C).

Changing the temperature setpoint will automatically deactivate the function.

#### **Attention:**

#### • **Incompatibility with the “Fast Cool” function**

To guarantee optimal performance, the “Vacation” and “Fast Cool” functions cannot be used at the same time.

Therefore, if the “Fast Cool” function has been already engaged, it has to be disengaged first to activate the “Vacation” function (and vice-versa).

#### **FAST COOL**

The use of this function is recommended when placing a very high quantity of food in the refrigerator compartment.

Using Fast Cool  function it is possible to increase the cooling capacity in the refrigerator compartment.

To maximize the cooling capacity, please keep the fan switch on.

#### **Attention:**

#### • **Incompatibility with the “Vacation” function**

To guarantee optimal performance, the “Vacation” and “Fast Cool” functions cannot be used at the same time.

Therefore, if the “Vacation” function has been already engaged, it has to be disengaged first to activate the “Fast Cool” function (and vice-versa).

#### **FAN**

The Fan improves temperature distribution inside the product, allowing better preservation of stored food.

By default, the fan is switched on.

It is advisable to keep the fan switched on:

- to improve the food preservation
- when the ambient temperature is above 27-28°C
- if you notice drops of water on the glass shelves
- in severe humidity conditions.

Please note that when the fan is switched on it will not continuously work. The fan will start/stop working depending on the temperature and/or humidity level inside the product. It is therefore absolutely normal if the fan does not move even if the fan is switched on.

To activate or deactivate this function - see enclosed Quick Start Guide.

**Attention:** Switching- off the Fan deactivate the Fresh Control Sensor.

**Note:**

**Do not obstruct the air intake area with food items.**

To guarantee the right performance at lower ambient temperature (colder than 18°C) and to minimize Energy Consumption, turn off the fan. To turn off the fan please see above procedure. If the appliance has the Fan it can be equipped with the antibacterial filter.

Remove it from the box placed in the crisper drawer and insert into the cover of fan.

The replacement procedure is included in the filter box.

### TEMPERATURE SETTING

The appliance is normally factory-set for operation at the recommended temperature of 5°C. The internal temperature can be adjusted between 8°C and 2°C, proceeding as follows:

- Press the temperature setting button . The storage temperature can be changed by -1°C with each pressure of the button: the value changes cyclically between 8°C and 2°C.

**Note:** Displayed set points correspond to the average temperature throughout the whole refrigerator.

## Use

### NOTES

- Do not block the air outlet area (on the back wall inside the product) with food products.
- If the freezer is provided with a flap, it is possible to maximize the storage volume by removing the flap.
- All shelves, flaps and pull-out baskets are removable.
- The internal temperatures of the appliance may be affected by the ambient temperature, frequency of door opening, as well as location of the appliance. Temperature setting should take into consideration these factors.

### NO-FROST REFRIGERATOR COMPARTMENT

Refrigerator compartment defrosting is completely automatic.

Droplets of water on the rear wall inside the refrigerator compartment indicate that the automatic defrost phase is in progress. The defrost water is automatically run into a drain hole and collected in a container, where it evaporates.

- Unless otherwise specified the appliance accessories are not dishwasher safe.
- Use Smart Display function as frequently as possible.

## “Fresh 0°” compartment

The “**Fresh 0°**” compartment is specifically designed to maintain a low temperature and the correct humidity to preserve fresh food for longer (for example, meat, fish).



Turning on and turning off the compartment.

The internal temperature of the compartment is approximately 0° when the compartment is turned on.

To turn on the compartment, press the button shown in the figure for more than one second until the symbol lights up.

The lit symbol means that the compartment is working. Press the button again for more than one second to turn off the compartment.

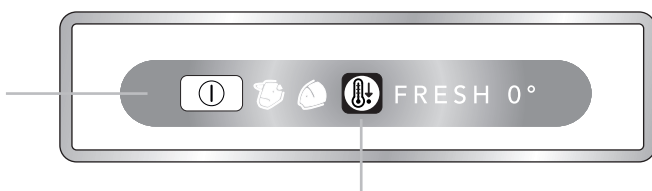

For the correct functioning of the “**Fresh 0°**” compartment, it is necessary that:

- the refrigerator compartment is turned on
- the temperature is between **+2°C** and **+6°C**
- the drawer in the “**Fresh 0°**” compartment must be inserted for it to be turned on
- one of the following special functions is not selected: Stand-by, Fast Cool, Vacation (if present), in this case, remove the food contained in it.

### Note:

- if the symbol does not light up when you turn on the compartment, check that the drawer is properly inserted; if the problem persists contact the authorised Technical Assistance Service.
- if the compartment is turned on and the drawer is open, the symbol in the control panel may automatically turn off. The symbol will light up again when the drawer is inserted
- regardless of the state of the compartment, you may hear a faint noise, which you should consider as normal
- when the compartment is not in operation, the temperature inside it depends on the general temperature of the refrigerator compartment. In this case, it is advised that fruits and vegetables that are not sensitive to cold (berries, apples, apricots, carrots, spinach, lettuce, etc.) are stored in it.

**Important:** if the compartment is turned on and food with a high water content is present, condensation may form on the shelves. In this case, turn the function off temporarily. Be careful when positioning food and containers that are small in size on the upper shelf of the “**Fresh 0°**” compartment in order to prevent them accidentally falling between the shelf and the back wall of the refrigerator compartment.

Removing the “**Fresh 0°**” compartment:

Carry out the following steps:

- to make it easier to remove the compartment, we recommend that you empty (and possibly remove) the lower door shelves
- turn off the compartment
- remove the compartment by rotating it upwards
- remove the white plastic shelf under the compartment.

**Note:** it is not possible to remove the upper shelf and side supports.

To use the “**Fresh 0°**” compartment again, carefully reposition the white plastic shelf under the compartment before inserting the drawer and turning the function back on.

To have a larger refrigerator volume and to reduce energy consumption, it is recommended that you turn off the “**Fresh 0°**” compartment and remove the compartment.

Clean the compartment and its components occasionally using a cloth and a solution of warm water (taking care not to submerge the white plastic shelf under the drawer) and neutral cleaning agents specifically for cleaning the inside of the refrigerator. Do not use abrasive cleaning agents.

**Before cleaning the compartment (also externally) it is necessary to remove the drawer to disconnect the electrical supply for the compartment.**

## Use of wooden accessories (if present)

### HAUTE CUISINE\*

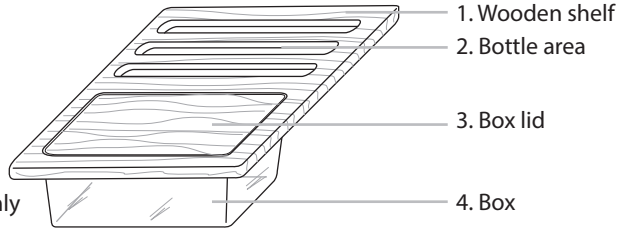

### Haute cuisine can be used in 2 different positions

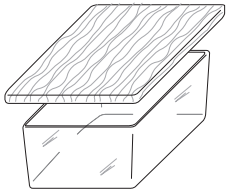

With the box below

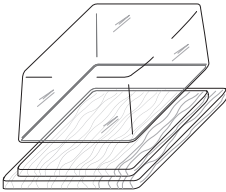
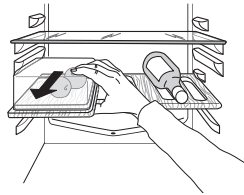
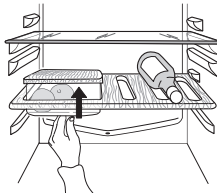
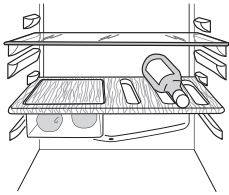

With the box on top,  
using the lid as a base

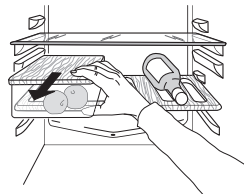
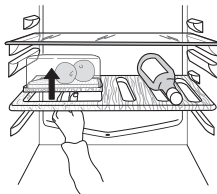
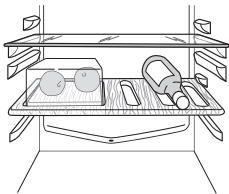

### CHEESE BOX\*

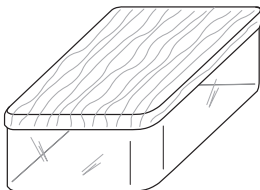

Both Haute cuisine and Cheese box can be used for serving food at the table. Do not use them in the freezer, microwave oven or on other heat sources. Do not chop food directly on the wooden surface as it may become scored.

#### Tips for cleaning:

Do not wash the wooden or plastic components in the dishwasher; we recommend washing them by hand with mild detergent, without the use of abrasive sponges.

## Food-storage tips

The refrigerator is the ideal storage location for ready meals, fresh and preserved food, dairy products, fruit and vegetables and beverage.

### AIR VENTILATION

- The natural circulation of air in the refrigerator compartment results in zones with different temperatures. It is coldest directly above the fruits and vegetables crisper and at the rear wall. It is warmest at the top front of the compartment.
- Insufficient ventilation results in an increase in energy consumption and reduction of the refrigerating performance.

### HOW TO STORE FRESH FOOD AND BEVERAGE

- Use recyclable plastic, metal, aluminum and glass containers and cling film to wrap foods.

- Always use closed containers for liquids and for food that may give off or be tainted by odor or flavor transfer or cover them.
- Foods which give off a large amount ethylene gas and those that are sensitive to this gas, such as fruit, vegetables and salad, should always be separated or wrapped so as not to reduce the storage life; for example do not store tomatoes together with kiwi fruits or cabbage.
- Do not store food too close together to enable sufficient air circulation.
- To avoid bottles falling over, you can use the bottle holder (available on selected models).
- If you have a little quantity of food to store in the refrigerator, we recommend to use the shelves above the crisper for fruits and vegetables since this is the coolest area of the compartment.

## Where to store fresh food and beverage

- On the fridge shelves: ready meals, tropical fruits, cheeses, deli.
- In the coldest area – Zero Degrees drawer\* (the one above Cooler Compartment): meat, fish, cold cuts, cakes.
- In the fruits and vegetables crisper: fruits, salad, vegetables.
- In the door: butter, jams, sauces, pickles, cans, bottles, beverage cartons, eggs.

## Example of food arrangement

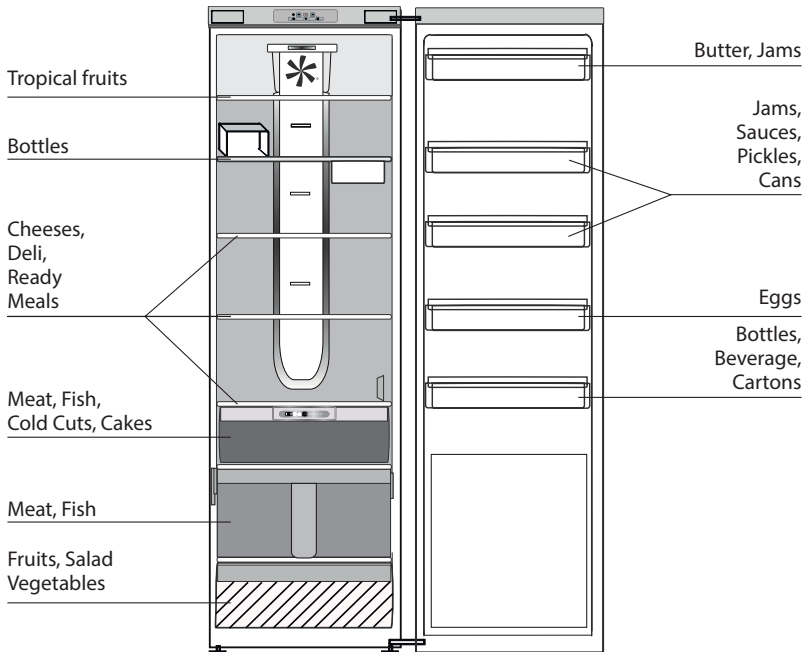

# Functional sounds

Sounds coming from your appliances are normal since it has a number of fans and engines to regulate performances that switch on and off automatically.

Some of the functional sounds can be reduced through

- Leveling the appliance and installing it on an even surface
- Separating and avoiding contact between the appliance and furniture.
- Checking if the internal components are correctly placed.
- Checking if bottles and containers are not in contact with each other.

Some of the functional sounds you might hear:

- A hissing sound when switching on the appliance for the first time or after a long pause.
- A gurgling sound when refrigerant fluid enters into the pipes.
- Buzzing sound when water valve or fan start working.
- A cracking sound when compressor starts or when ready ice drops into ice box abrupt clicks when compressor switches on and off.

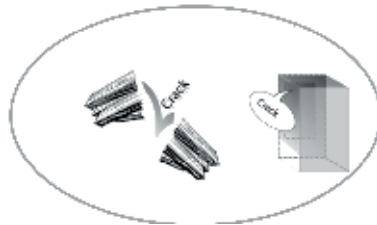
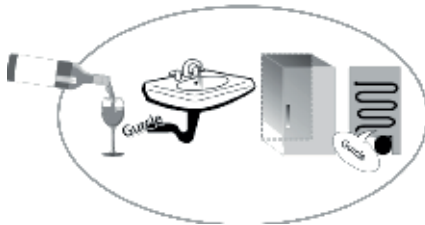
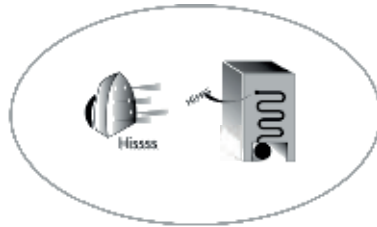
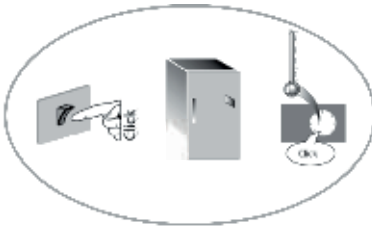



## Recommendation in case of no use of the appliance

### ABSENCE / VACATION

In case longer absence its recommended to use up food and to disconnect the appliance to save energy.

### MOVING

1. Take out all internal parts.
2. Wrap them well, and fix them together with adhesive tape so that they do not bang together or get lost.
3. Screw the adjustable feet so that they do not touch the support surface.
4. Close and fix door with adhesive tape and, again using adhesive tape, fix the power cable to the appliance.

### POWER FAILURE

In the event of a power failure, call the local office of your electricity supply company and ask how long it is going to last.

**Note:** Bear in mind that a full appliance will stay cold longer than a partially filled one.

If food is found to be in a poor condition, it is best to throw it away.

#### For power failures lasting up to 24 hours.

1. Keep the door of the appliance closed. This will allow the stored food to stay cold as long as possible.

#### For power failures lasting more than 24 hours.

1. Try to use up the food, which is more easily perishable.

## Maintenance and cleaning

Before any cleaning or maintenance operation, unplug the appliance from the mains or disconnect the electrical power supply. Periodically clean the appliance with a cloth and a solution of lukewarm water and neutral detergent specifically for refrigerator interiors. Never use abrasives. Never clean refrigerator parts with flammable fluids. The fumes can create a fire hazard or explosion. Clean the outside of the appliance and the door seal with a damp cloth and dry with a soft cloth.

Do not use steam cleaners.

Condenser placed in the rear of the appliance should be cleaned regularly using a vacuum cleaner.

Condenser placed in the rear of the appliance should be cleaned regularly using a vacuum cleaner.

### Important:

- The buttons and control panel display must not be cleaned with alcohol or alcohol-derived substances, but with a dry cloth.
- The refrigeration system pipes are located near the defrost pan and can become hot. Periodically clean them with a vacuum cleaner.

To ensure continuous and correct flow of defrost water, regularly clean the inside of the draining hole on the back of the refrigerator near the fruit and vegetable drawer, using the tool provided .

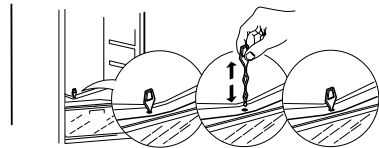
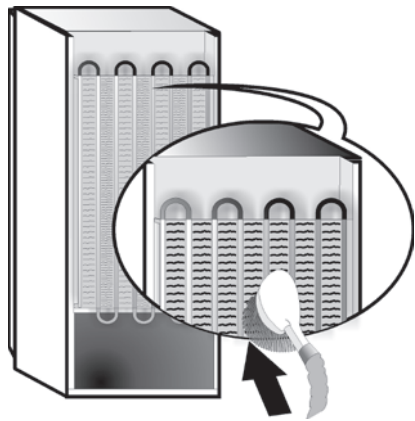

## Troubleshooting guide



### BEFORE CONTACTING AFTER-SALES SERVICE...

Performance problems often result from little things you can find and fix yourself without tools of any kind.

<b>PROBLEM</b>	<b>SOLUTION</b>
<b>The appliance is not working:</b>	<ul style="list-style-type: none"><li>- Is the power cable plugged into a live socket with the proper voltage?</li><li>- Have you checked the protection devices and fuses of the electrical system in your home?</li></ul>
<b>If there is water in the defrost pan:</b>	<ul style="list-style-type: none"><li>- This is normal in hot, damp weather. The pan can even be half full. Make sure the appliance is level so that the water does not overflow.</li></ul>
<b>If the edges of the appliance cabinet, which come in contact with the door seal, are warm to the touch:</b>	<ul style="list-style-type: none"><li>- This is normal in hot weather and when the compressor is running.</li></ul>
<b>If the light does not work:</b>	<ul style="list-style-type: none"><li>- Have you checked the protection devices and fuses of the electrical system in your home?</li><li>- Is the power cable plugged into a live socket with the proper voltage?</li><li>- In case the LEDs are broken the user must call the Service for exchange of the same type available only at our After-sales Service Centers or authorized dealers.</li></ul>
<b>If the motor seems to run too much:</b>	<ul style="list-style-type: none"><li>- Motor running time depends on different things: number of door openings, amount of food stored, temperature of the room, setting of the temperature controls.</li><li>- Is the condenser (back the appliance) free of dust and fluff?</li><li>- Are the door properly closed?</li><li>- Are the door seals properly fitted?</li><li>- On hot days or if the room is warm, the motor naturally runs longer.</li><li>- If the appliance door has been left open for a while or if large amounts of food have been stored, the motor will run longer in order to cool down the interior of the appliance.</li></ul>
<b>If the appliance temperature is too high:</b>	<ul style="list-style-type: none"><li>- Are the appliance controls correctly set?</li><li>- Has a large amount of food been added to the appliance?</li><li>- Check that the door is not opened too often.</li><li>- Check that the door close properly.</li></ul>
<b>If the doors do not open and close properly:</b>	<ul style="list-style-type: none"><li>- Check that food packages are not blocking the door.</li><li>- Check that the internal parts or automatic icemaker are not out of position.</li><li>- Check that the door seals are not dirty or sticky.</li><li>- Ensure the appliance is level.</li></ul>

## FAILURES

In the event of operation alarms, they will also be displayed in the digits LEDs, (e.g. Failure 1, Failure 2, etc...) call After-sales Service and specify the alarm code. The acoustic alarm sounds, the Alarm icon  lights up and the F letter on the digit display blinks according to failure code described below:

Failure code	Visualization
Error 2	F letter blink on/off at 0,5 sec. Blinks ON 2 times then remain off for 5 seconds. Pattern repeats.  x2
Error 3	F letter blink on/off at 0,5 sec. Blinks ON 3 times then remain off for 5 seconds. Pattern repeats.  x3
Error 6	F letter blink on/off at 0,5 sec. Blinks ON 6 times then remain off for 5 seconds. Pattern repeats.  x6

## After-sales service

### Before contacting After-Sales Service:

Switch the appliance on again to see if the problem has been solved. If it has not, disconnect the appliance from the power supply and wait for about an hour before switching on again.

If, after performing the checks described in the Troubleshooting Guide and switching the appliance on again, your appliance still does not work properly, contact the After-sales Service, explain the problem.

Specify:

- the model and appliance serial number (stated on the rating plate),
- the nature of the problem,
- the Service number (the number after the word SERVICE on the data plate on the inside of the appliance),
- your full address,
- your telephone number and area code.

**SERVICE** 0000 000 00000



### Note:

**The direction of door opening can be changed. If this operation is performed by After-sales Service it is not covered by the warranty.**



FOR THE WAY IT'S MADE.

Printed in Italy  
04/17

**19514595501**

